

THE GUIDE TO STANDARD AXLES

APPLICATION GUIDE

| SPINDLE | CAPACITY (LBS) | TUBE OD | WALL THICKNESS | APPLICATION |
|-----------------------------|----------------|---------|------------------|------------------------------------|
| F12 | 13,200 | 5" | S-Wall | Light Duty, Aux Truck |
| F22/F23 (Tapered) | 25,000 | 5" | H-Wall | Vans & Flats |
| | 25,000 | | T-Wall | Dumps, Tanks, Live Loads, Off-Road |
| F24 (Parallel) | 25,000 | 5" | H-Wall | Vans & Flats |
| | 26,000 | | T-Wall | Dumps, Tanks, Live Loads, Off-Road |
| F26 | 30,000 | 5-3/4" | S-Wall -5-3/4" | Severe Duty, Specialty |
| K45 | 45,000 | 5-3/4" | Solid 5-3/4" Bar | Extreme Duty, Specialty |

SPINDLE TYPES

F12

Bearing Group:
Inner Cone HM212049
Outer Cone:

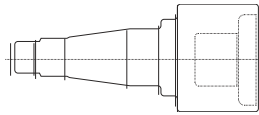

The F12 uses the same bearings, hubs and brake components as the most popular North American truck front steering axle. The brakes are 15"x4". The rugged axle is a friction welded product, and is a manufactured with a seamless 5" round tube.

F22/F23

Bearing Group:
Inner Cone: HM218248
Outer Cone: HM212049

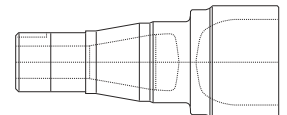

The F22 tapered spindle configuration is accepted as the most used axle in North America. The F22 spindle has durability which is unsurpassed. Also, Ingersoll Axles has the widest range of certified brake linings in North America (FMVSS121, CMVSS121). All components are off the shelf and available throughout North America, the Far East and the Pacific Rim.

F26

Bearing Group:
Inner Cone 759
Outer Cone 740

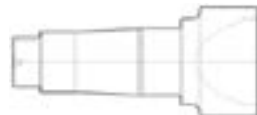

The F26 series axle are first choice for both on-highway and off-highway "extra heavy-duty use." The durability of the F26 series sets the standard throughout the North American logging industry, as well as South America and Africa.

F24

Bearing Group:
Inner Cone HM518445
Outer Cone: HM518445

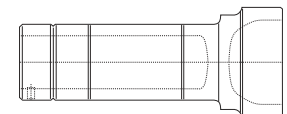

The F24 parallel spindle is recognized world-wide and the F24 finds service in the African bushlands, throughout North and South America and Europe. The axle has a wide range of applications and is the preferred axle for heavy-duty bulk tanker containers.

F23

Bearing Group:
Inner Cone HM218248
Outer Cone: X333213

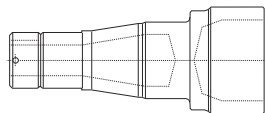

Developed for overseas market, especially Europe, certified to EC-13 brake code. Available with cast steel or aluminum, regular, and Pre-Set™ hubs.

To view our full line of products and services, please visit www.ingersollaxles.com